



The Sandford 3 bedroom home

karbon
homes

For more information please contact us on:
salesandmarketing@karbonhomes.co.uk / 0191 223 8749

The Sandford is a three bedroom home ideal for couples and families alike. The ground floor features an open plan kitchen, dining and living area with French doors. There is also a handy storage cupboard and W.C.

To the first floor, you will find three bedrooms and a family bathroom with en-suite to the master bedroom. Externally, there is private parking and a rear garden.

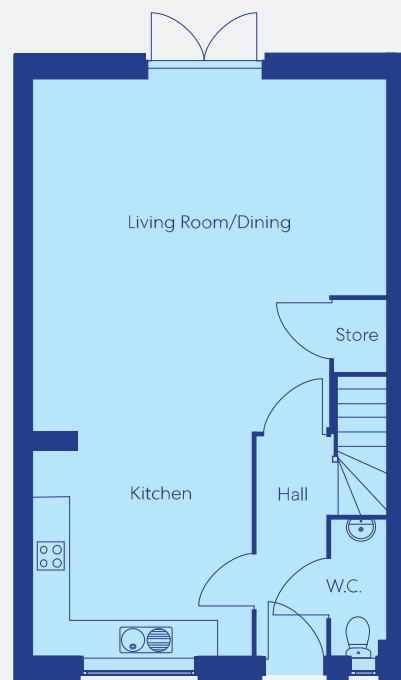

Ground Floor

Living Room/Dining
5.36m x 5.38

Kitchen
3.43m x 3.21m

W.C.
2.09m x 0.90m

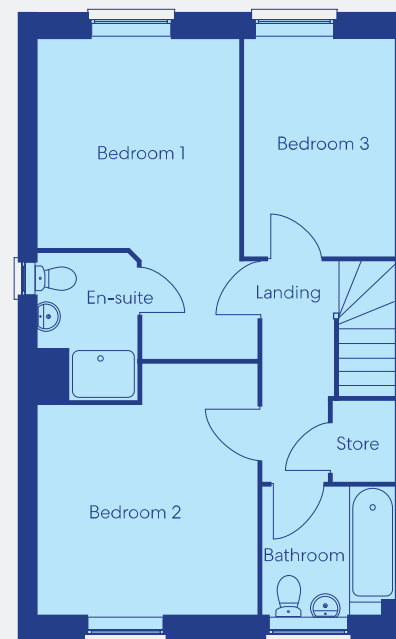

First Floor

Bedroom 1
3.18m x 2.99m

Bedroom 2
3.82m x 3.27m

Bedroom 3
3.30m x 2.29m

En-suite
2.20m x 1.38m

Bathroom
1.94m x 2.01m